

# Wear Pad Design Worksheet

PROVIDE DETAILS IN BOX TO THE RIGHT

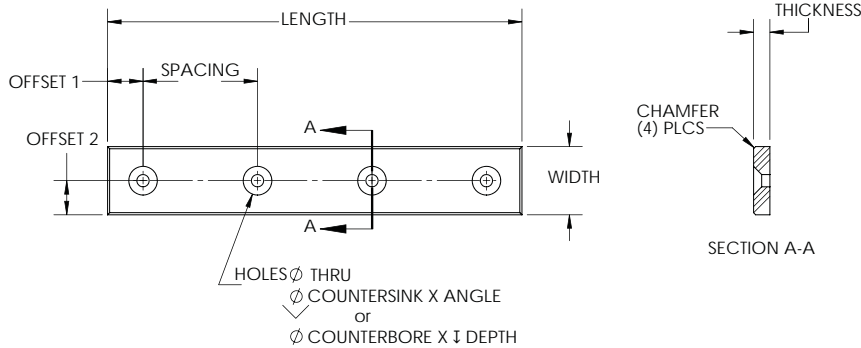

### DIMENSIONS

*Provide hardware dimensions below.*

Length Min \_\_\_\_\_ /Max \_\_\_\_\_  
 Width Min \_\_\_\_\_ /Max \_\_\_\_\_  
 Thickness Min \_\_\_\_\_ /Max \_\_\_\_\_

### COUNTERSUNK HOLES

Spacing \_\_\_\_\_  
 Offset 1 \_\_\_\_\_ Offset 2 \_\_\_\_\_  
 Holes \_\_\_\_\_ X  $\varnothing$  \_\_\_\_\_ Thru  
  $\varnothing$  \_\_\_\_\_ Countersink X  82°  90°  
  $\varnothing$  \_\_\_\_\_ Counterbore X  $\downarrow$ Depth \_\_\_\_\_

### CONTACT INFORMATION

Company \_\_\_\_\_ Name \_\_\_\_\_  
 Phone \_\_\_\_\_ Fax \_\_\_\_\_ E-Mail \_\_\_\_\_

### HARDWARE INFORMATION

Mating Surface Material (required): \_\_\_\_\_  
 Finish: \_\_\_\_\_

### ENVIRONMENT

Temperature Min. \_\_\_\_\_ Max. \_\_\_\_\_ Normal Operation \_\_\_\_\_  
 Pressure/Load \_\_\_\_\_ psi/lbs

### LUBRICATION

Water:  Grease:  Oil:  None:

### SPEED / MOTION

Linear \_\_\_\_\_ Feet/min.

### MANUFACTURING OPTIONS

- Raw Material (raw sheet is supplied with additional material allowance for machining)
- Semi-Finished (CIP to rough turn machine)
- Finished Machined (CIP to machine complete to design)

### ORDER DETAILS

CIP Material: \_\_\_\_\_ Quantity Needed: \_\_\_\_\_

*CIP Only:*  
 Raw Tube: \_\_\_\_\_  
 Mandrel Size: \_\_\_\_\_

### APPLICATION: